

# Grant County Comprehensive Land Use Plan Lura Township Future Land Use Map

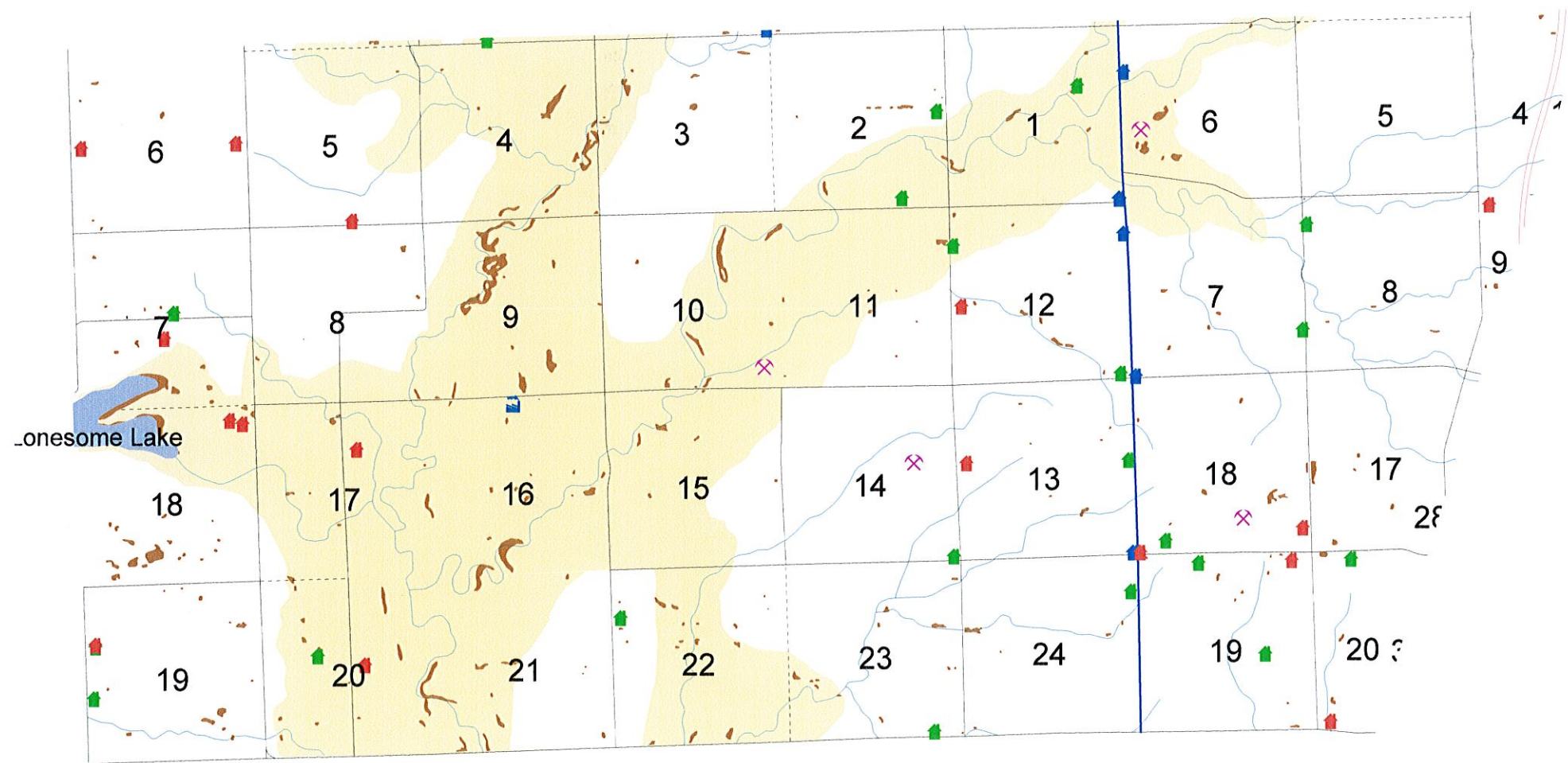

- Area of Development Advantage
- Area of Development Transition
- Area of Development Stability
- Area of Development Limitation - Wellhead Protection Area
- Area of Development Limitation - Shallow Aquifer
- Area of Development Limitation - 100 Year Floodplain
- Area of Development Limitation - Wetland
- Lake
- Stream
- Paved State Highways/I-29
- Paved County Highways
- Gravel Roads
- Unimproved Roads
- Railroad

- Airport
- Bulk Plant
- Cemetery
- Golf Course
- Gravel Pit
- Other
- Park
- Sports Field
- Utility
- Business
- Church
- Elevator
- Government Office
- School
- Town Hall
- Existing Farm Residence
- Existing Non-farm Residence
- Abandoned Residence
- Other